

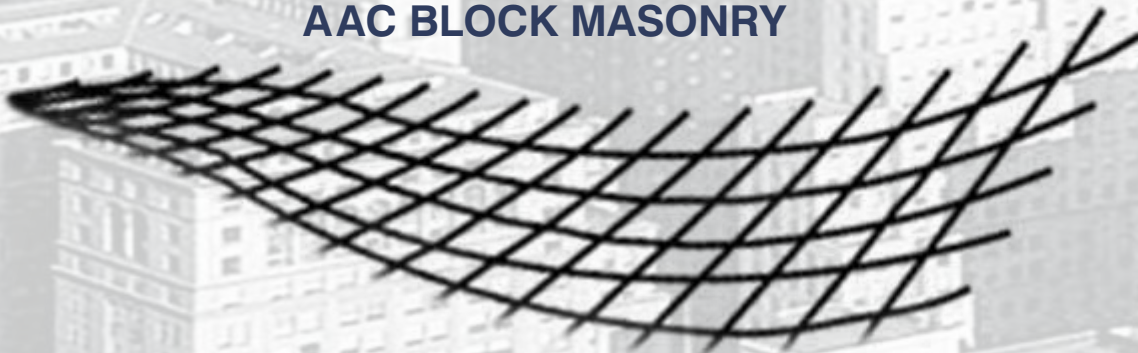

Let's Build Green

TBM-REINFORCEMENTTM
FOR
AAC BLOCK MASONRY

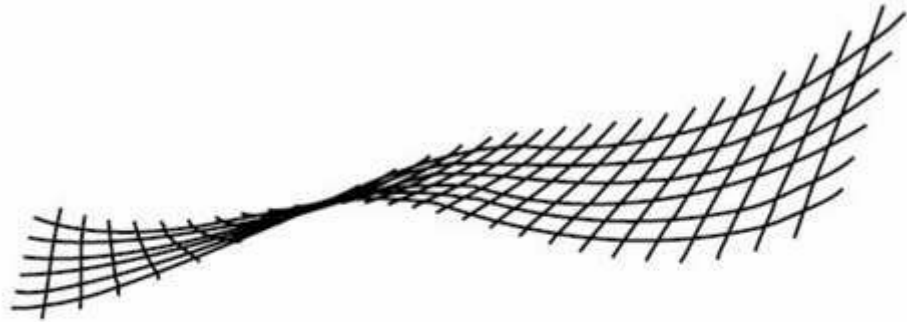



PRODUCT DESCRIPTION

TBM-REINFORCEMENT is manufactured from high tensile silica fiber made from very fine strands of glass which is coated with high modulus proprietary alkaline resistant chemical & is designed for bonding & strengthening AAC Block Masonry work.

TBM-Reinforcement lies flat on the masonry mortar joint making the product easy to install. Although TBM-Reinforcement cannot be used structurally, test work carried out has shown its use contributes significantly to enhance the strength of masonry by absorbing tensile stresses which can develop in masonry construction.

A BUILDING PROJECT HOLDS MANY CHALLENGES. CONTROLLING CRACKING IN YOUR MASONRY IS ONE OF THEM.

- Thin Bed-Joint Reinforcement is a proven method to control AAC Block Masonry cracks.
- It enhances the durability and safety of your construction and ensures Longer lifetime.
- TBM-REINFORCEMENT create an engineered reinforcement that will help you control crack formation and make more inspiring designs which are better able to withstand the forces of nature.

IN FULL CONTROL OF YOUR MASONRY

- As a construction material, masonry has good compressive strength properties but is weak in tension.
- Reinforcing your masonry with TBM-REINFORCEMENT however, provides additional strength and flexibility and give you full control in design and performance of your work.

BUILDING WITHOUT COMPROMISE

- As an architect or designer, you sometimes have to sacrifice your freedom for the strength of your construction.
- TBM-REINFORCEMENT enhances your freedom of design and reconciles the competing interests of aesthetics and performance.

THE SAFE CHOICE

- Building in seismic areas can be challenging. As a construction professional, it can be hard to prepare for earthquakes or heavy winds.
- TBM-REINFORCEMENT is a smart and economical way to protect building subject to high wind conditions and in seismic areas.

KEY FEATURES

- Bonds and strengthens corners and wall intersections.
- Resists cracking in areas of uneven settlement.
- Bonds wall to reinforced concrete frames.
- Safe to handle, easy to cut on site.
- Control crack formation more efficiently.
- Exploring new structural possibilities without compromise.
- Safeguarding your investment in seismic areas.
- Greatly reduces cracking that can arise from thermal stresses.
- Enhances resistance to water penetration, as cracks are controlled.
- Increases performance of masonry walls under various stresses.
- UV resistance.
- High tensile strength than steel as compared to the weight ratio.
- Alkali resistance.
- Rust & corrosion proof.
- Fire resistant.
- Eco Friendly & Non Toxic.
- Zero wastage.
- Easy to carry due to light weight.

TECHNICAL PARAMETERS

| Properties | Specifications |
|-----------------------------|--|
| Material | Connected strands of silica glass coated with polymeric chemical |
| Color | Black |
| Tensile Strength (MD X CMD) | 25 x 25 KN/MTR |
| Tensile Elongation | 3% (+/-0.5) |
| Melting Point of Coating | >250°C |
| Aperture | 10 x 10 MM |
| Shelf life | Long term |
| Pack size | (90/115/140/190/215/285) MM x 50 MTR Roll |

• MD - Machine Direction • CMD - Cross Machine Direction • The right is reserved to make changes without notice at any time.

• The values given are indicative & correspond to average results obtained in our laboratories & testing institutes.

Your Proven Solution for Confident Building.

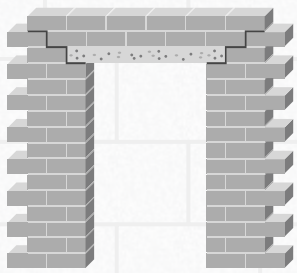

Problem

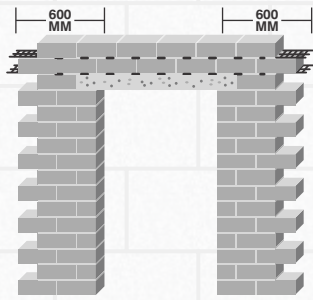

Solution

Door Opening

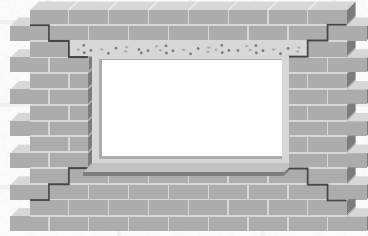

Problem

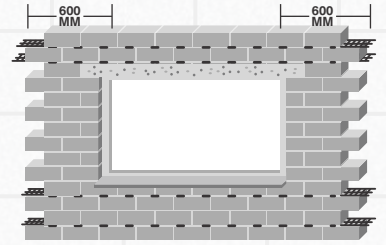

Solution

Window Opening

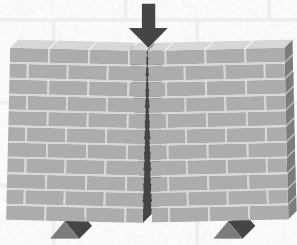

Problem

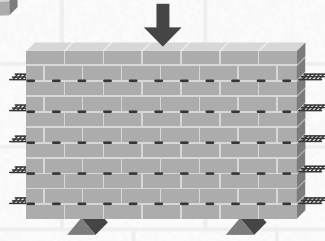

Solution

Masonry Work

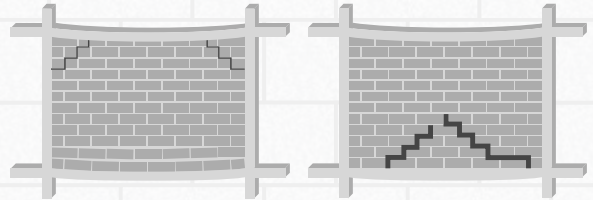

Problem

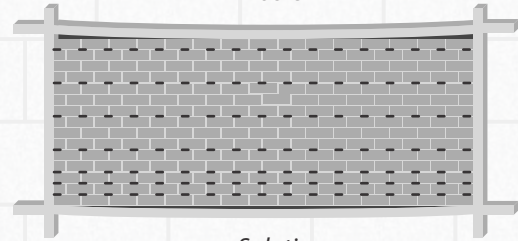

Solution

Partition Wall

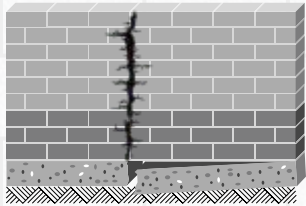

Problem

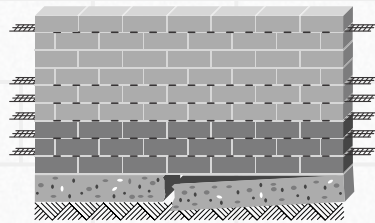

Solution

Allowance for Differential Settlement

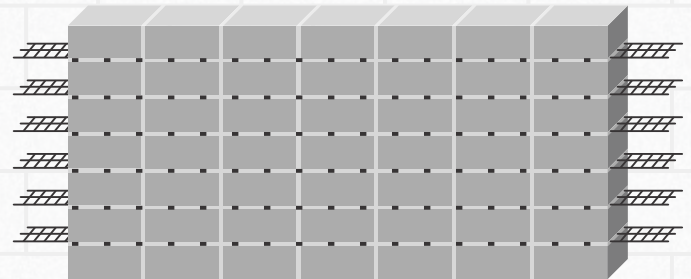

Stack Bonded and Banded Masonry

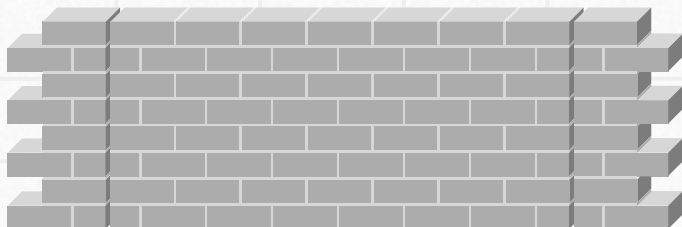

Problem

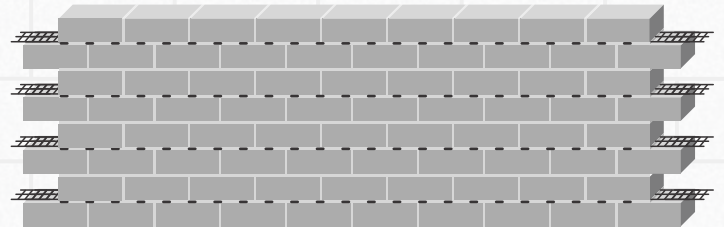

Solution

Movement Joint



MAP PRODUCTS PVT. LTD.

101- Labh, Shukan Tower, Above A.D.C. Bank, Judges Bunglow, Bodakdev, Ahmedabad - 380054.
Ph.: +91- 75748 09626 • info@mapaac.in • www.mapaac.in

*TERMS & CONDITIONS APPLY